

REV A 12-08-05 CONVERT ALL DIMENSIONS TO 2 PLACE DECIMAL TOL.

PART NO.	"A" DIMENSION	"B" DIMENSION
SLP-2	2.25"	1.88"
SLP-3	3.00"	2.31"
SLP-4	4.00"	3.25"
SLP-6	6.00"	4.25"
SLP-8	8.00"	5.50"

MATERIAL IS: 16 GAUGE TYPE 316L SS  
FINISH: NONE

ALTERNATE MATERIAL: 16 GA. 1008-1010 CRS  
FINISH: ELECTRO ZINC PLATE

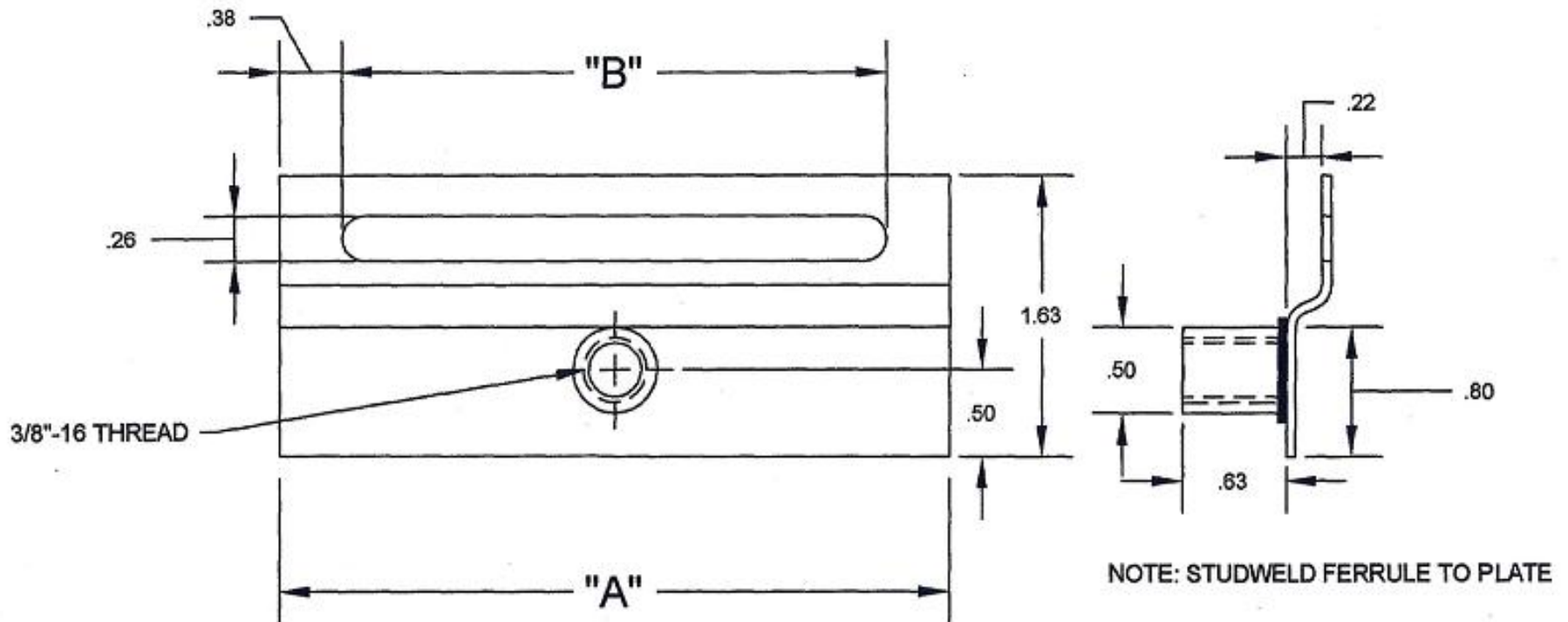

SIZE: <b>A</b>	DIMENSIONS IN INCHES DO NOT SCALE DRAWING	TOLERANCES UNLESS OTHERWISE SPECIFIED	Production Fastening Systems, L.L.C.	New Orleans, LA	
	THIRD ANGLE PROJECTION	DECIMAL:    XX ± .08 XXX ± .005 XXXX ± .0005  ANGULAR:    ALL ± 1°		DESCRIPTION: <b>SLP PNEUMATIC TUBE HANGER</b>	DRAWING #: <b>SLP - XSS</b>
			SCALE: —	DATE: APRIL 1, 2005	